

FEATURES

EM-SIGN is a stylish and compact double-sided LED exit sign suitable for recessed applications. It features a plexiglass screen printed legend plate which offers an impressive 25m viewing distance. Available in either a switchable maintained/non-maintained or a DALI self-test version.

The legend exit sign panels are available in arrow up, arrow down and arrow left/right. When ordering please note that all legend panels are single sided, apart from the arrow left/right which is double sided.

- White polycarbonate body
- Protective legend panel cover
- IP41



SPECIFICATION

| | |
|----------------------------------|---|
| Input Voltage | 230 – 240V AC 50/60 Hz |
| Recharge period | 12 hours |
| Duration | 3 hours |
| Viewing Distance | 25m |
| IP Rating | IP41 |
| Material | White polycarbonate body |
| Panel Dimensions | W 250 mm x H 125 mm x W 6 mm |
| Recessed Module Dimensions | W 300 mm x H 70 mm x W 42 mm |
| Legend Arrows | Arrow up, arrow down and arrow left/right |
| Conformity | BS 61000-3-3:2013+A2:2021, BS 61347-1:2015+A1:2021, BS EN IEC 62031:2020+A11:2021, UKCA |
| Warranty | 5 Years |
| Switchable Maintained | |
| Power | 2W 44mA $\lambda = 0.6$ |
| Battery Type | 6.4V 1.6Ah LiFePO4 Cells |
| Charge Current | 0-400mA Dual Rate |
| Weight | 1.00 Kg |
| DALI Self-test Maintained | |
| Power | 2W 40mA - $\lambda = 0.6$ |
| Battery Type | 3.2V 4.5Ah LiFePO4 Cells |
| Charge Current | 0-150mA Dual Rate |
| Weight | 1.10 Kg |

DIMENSIONS

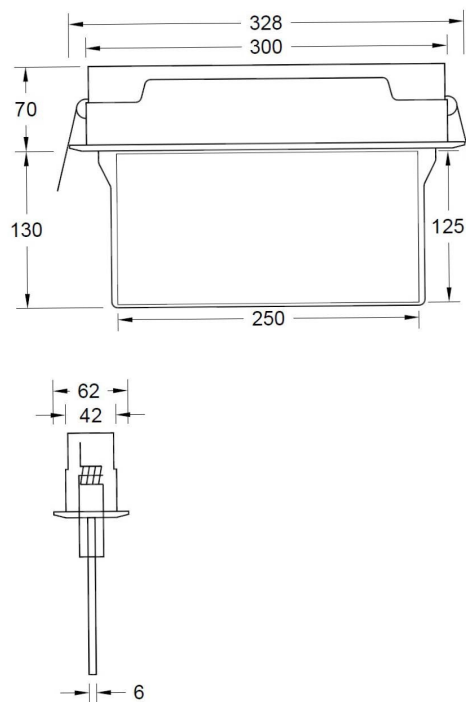

PRODUCT ORDER CODE

EXAMPLE: EM-SIGN/REC/DEM/AU

| PREFIX | INSALLATION | EMERGENCY | LEGEND PANELS |
|---------|-----------------|--|---|
| EM-SIGN | REC recessed | SM switchable maintained DEM DALI self-test maintained via mains switch | AU arrow up AD arrow down ALAR arrow left/right – double sided |

