

FEATURES

The TESNI is a powerful and elegant high/low bay pendant luminaire, available in a choice of finishes. Incorporating the Philips Fortimo DLM Flex and Xitanium driver.

- Efficacy up to 111 lm/W
- High efficiency clear PMMA refractor
- White, grey or black finish
- Emergency options
- CRI80
- IP20



SPECIFICATION

Luminous Flux	1025 - 4550 Lumens
Colour Temperature CCT	3000K 4000K
Power Consumption	10W 20W 30W 46W
CRI	>80
Efficacy	99 - 111 lm/W
Dimming	Fixed Output 1-10V DALI
Operating Voltage	220 – 240V
Operating Frequency	50-60Hz
Lifetime	60,000hrs
Finish	White Grey Black
Installation	Pendant - 2m or 5m suspension kit
Dimensions	Ø 416 mm x 390 mm
Material	Aluminium Housing/Clear PMMA Refractor
Ingress Protection	IP20
Weight	2.8 kg
Operating Temperature	-25°C ~35°C
Conformity	Thermal Management System No UV or IR Emissions, UKCA
Warranty	5 Years

DIMENSIONS

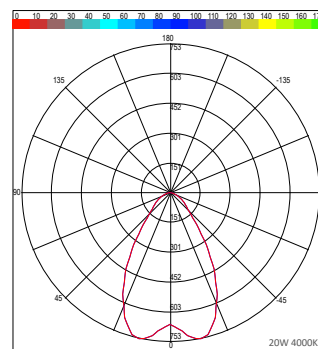
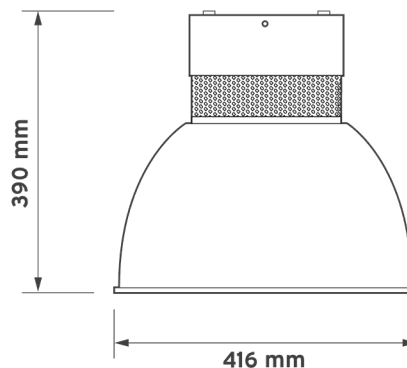

PRODUCT ORDER CODE

EXAMPLE: TESNI/20W/4K/DALI/BL

PREFIX	WATTAGE	CCT	DRIVER	FINISH	EMERGENCY	CASAMBI
TESNI	10W	3K 3000K	FO fixed output	WH white	ST standard emergency	CAS casambi
	20W	4K 4000K	10 1-10V	GR grey	DEM dali emergency	
	30W		DALI DALI dimming	BL black		
	46W					